

Project No: **BDHRN002**Job Card No **0028**

Notif.No.: 10049058

Activity: **1001**

Rev No: 20000622

Model.: F900EX

Sheet 1 of 1

A/C Regn: **D-AHRN**

Serial No.: 096

Type: F900EX

Starting Phase: Inspect

Starting Work Centre: FALCON A/C TEAM

Job Description: **GVI Thrust Reverser**

ETOPS A/C: No

RVSM A/C: No

Warranty: -

ATA: 78

Check Type: 2A CHECK

Work Center	
FALCON A/C	

Zone: 300

Corrective Action

0001	Task carried out in accordance with the attached Customer Card that quotes the Operator code detailed below.					 Order: 80069292 Operation: 0010 Phase: Inspect - scheduling activity Work Center:FALCON A/C TEAM
	Accomplished		Inspected			
	Pers. No.	Date	Pers. No.	Date		
	Stamp		Stamp			

Completed & Confirmed on SAP IAW MOE 2.13.

Defect Card Raised

Components Removed/Installed

	Part Number	Part Name	S/N	Location	Comm. Off/On
OFF					
ON					
OFF					
ON					
OFF					
ON					
OFF					
ON					

Occurance Report Raised? YES ☐

Operations Above & Notifications Completed IAW MOE 2.13.

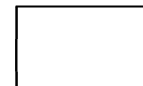

OEM Code: 78-30-00-210-801

Operator Code: 78-30-00-210-801-01

Form No: JA-SAP-MTX-002

Printed by: ADAMOVIC G



Printed: 03.09.2012

13:34:17

Print No: 1

Operator: **HERON AVIATION**

Work Card No.: **78.010**

Serial No.: **096**

Model: **FALCON 900EX**

PKG # 2 2A INSPECTION

Reg No.: **D-AHRN**

Workorder No.: _____

	Date	A/C HRS	AFL	APH			
Due At	25-NOV-2012	4410:47					
Accomplished							

TECHNICIAN SIGNATURE: _____ KIND OF CERTIFICATE & NO.: _____

INSPECTED BY: _____ KIND OF CERTIFICATE & NO.: _____

TECH	INSP	LABOR-HRS HRS.MINS
------	------	-----------------------

**>78-30-00-210-801- GENERAL VISUAL INSPECTION OF THE THRUST REVERSER
01**

REMARKS : _____

AMM 78-30-00-210-801

FALCON 900EX AIRCRAFT MAINTENANCE MANUAL

TASK 78-30-00-210-801

GENERAL VISUAL INSPECTION OF THE THRUST REVERSER

1. OVERVIEW OF THE JOB

Operation code: 78-30-00-210-801-01

2. LOGISTICS

A. References

Reference	Designation
• 78-30-00-910-802	DEPLOYMENT / STOWING OF THE THRUST REVERSER
• 78-31-09-350-801	REPAIR OF THE THRUST REVERSER DOOR SEALS

B. Ingredients and Consumable Products

Designation	Additional designation
• P-D-680B	WHITE SPIRIT

C. Energy

- ELECTRICAL
- HYDRAULIC

D. Access

Reference	Designation
• 454CT	THRUST-REVERSER UPPER FAIRING
• 454EB	THRUST-REVERSER LOWER FAIRING

3. PRELIMINARY STEPS

- A. Deploy the Thrust Reverser (Refer to [TASK 78-30-00-910-802](#), paragraph "Depressurization of Thrust Reverser Accumulator (190KR)").
- B. Remove thrust-reverser fairings ([454CT](#)) and ([454EB](#)).
- C. Using [P-D-680B](#), clean contaminated areas of the thrust reverser afterbody and more especially the TR door inner skin.

4. CHECKS

Refer to **fig. 1** and **fig. 2**

CAUTION: IF A CRACK IS DETECTED, CONTACT AN APPROVED REPAIR AGENT.

A. Check the TR doors as follows (see **fig. 1**):

- (1) Check inner and outer skins for cracks, distortion and corrosion.
- (2) Check riveting for condition, especially in the vicinity of the hinge pins.
- (3) Check the abutment plate for security, cracks, marks, distortion or corrosion.

FALCON 900EX AIRCRAFT MAINTENANCE MANUAL

(4) Check condition of overstop adjustable stop and of latch hook receptacles.

B. Check link rods as follows:

(1) Check link rod body for cracks, distortion (buckling), corrosion and impacts.

(2) Check correct safetying of adjustable clevis (on TR door side).

C. Check TR door seals area as follows (see **fig. 1**):

(1) Check the seal support for condition: cracks and distortion, riveting (torn out or loose rivets).

(2) Check the seal and attachment for condition.

(3) If necessary, repair the seal (Refer to **TASK 78-31-09-350-801**).

D. Check actuators as follows:

(1) Check couplings for hydraulic fluid seepage.

(2) Check full deploy switch for condition (lower actuator only).

E. Check TR door latch box assemblies as follows:

(1) Check latch hooks for condition.

(2) Check spring blades for condition.

F. Check hydraulic lines as follows:

(1) Check line attachment to structure.

(2) Check that the lines are not in contact with the structure.

(3) Check there is no hydraulic fluid leakage at the couplings and self-sealing valves of hoses on the engine pylon.

G. Check electrical wiring as follows:

(1) Check wiring for condition, routing and attachment.

(2) Check wiring connectors for correct connection.

H. Check brackets (1-fig. 2) for damage.

5. FINAL STEPS

A. Install thrust-reverser fairings (**454CT**) and (**454EB**).

B. Stow the Thrust Reverser (Refer to **TASK 78-30-00-910-802**, paragraph "Thrust Reverser Stowing after Depressurization of Thrust Accumulator (190KR)").

FALCON 900EX AIRCRAFT MAINTENANCE MANUAL

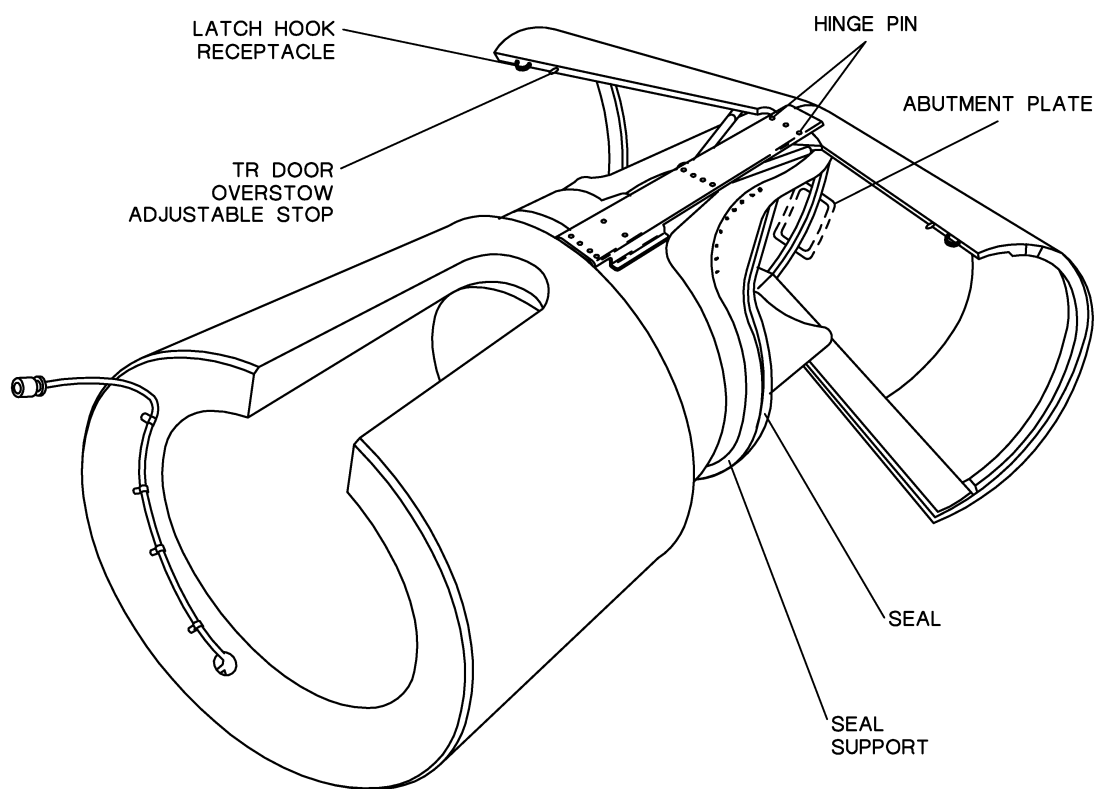
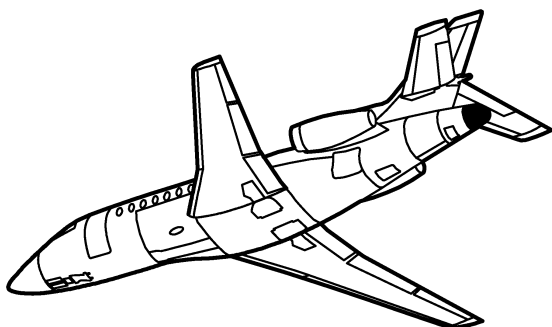

Figure 1: VISUAL CHECK OF THRUST REVERSERS

FALCON 900EX AIRCRAFT MAINTENANCE MANUAL

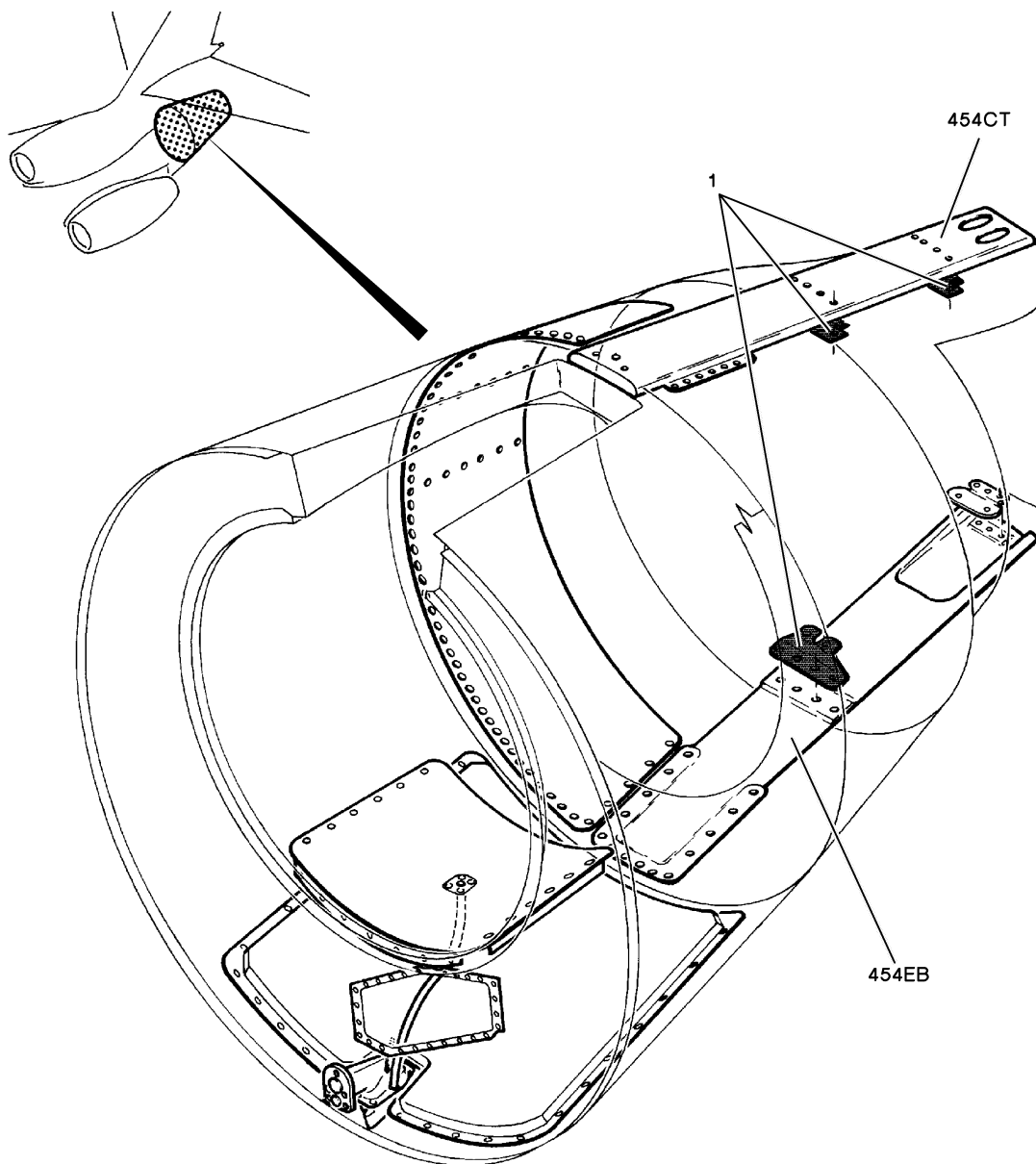

Figure 2: CHECK OF BRACKETS