

Project No: **BDHRN002**Job Card No **0056**

Notif.No.: 10049105

Activity: **1003**

Rev No: 20000622

Model.: F900EX

Sheet 1 of 1

A/C Regn: **D-AHRN**

Serial No.: 096

Type: F900EX

Starting Phase: Routine

Starting Work Centre: FALCON A/C TEAM

Job Description: **SERV Park Brake Control**

ETOPS A/C: No

RVSM A/C: No

Warranty: -

ATA: 32

Check Type: 2A+ Inspection

Work Center	
FALCON A/C	

Zone: 200**Access Required for this task:**

252CR,PAX

Corrective Action

0001	Task carried out in accordance with the attached Customer Card that quotes the Operator code detailed below.					 Order: 80069271 Operation: 0010 Phase: Routine - scheduling activity Work Center:FALCON A/C TEAM
	Accomplished		Inspected			
	Pers. No.	Date	Pers. No.	Date		
	Stamp		Stamp			

Completed & Confirmed on SAP IAW MOE 2.13.

Defect Card Raised

Components Removed/Installed

	Part Number	Part Name	S/N	Location	Comm. Off/On
OFF					
ON					
OFF					
ON					
OFF					
ON					
OFF					
ON					

Occurance Report Raised? YES ☐

Operations Above & Notifications Completed IAW MOE 2.13.



OEM Code: 32-42-00-610-801

Operator Code: 32-42-00-610-801-01

Form No: JA-SAP-MTX-002

Printed by: ADAMOVIC G



Printed: 03.09.2012

13:34:17

Print No: 1

Operator: **HERON AVIATION**

Work Card No.: **32.370**

Serial No.: **096**

Model: **FALCON 900EX**

PKG # 12 2A+ INSPECTION

Reg No.: **D-AHRN**

Workorder No.: _____

	Date	A/C HRS	AFL	APH			
Due At	25-NOV-2012						
Accomplished							

TECHNICIAN SIGNATURE: _____ KIND OF CERTIFICATE & NO.: _____

INSPECTED BY: _____ KIND OF CERTIFICATE & NO.: _____

TECH	INSP	LABOR-HRS HRS.MINS
------	------	-----------------------

**>32-42-00-610-801- SERVICING OF THE PARK BRAKE CONTROL CABLE
01**

REMARKS : _____

AMM 32-42-00-610-801

FALCON 900EX AIRCRAFT MAINTENANCE MANUAL

TASK 32-42-00-610-801 SERVICING OF THE PARK BRAKE CONTROL

1. OVERVIEW OF THE JOB

Operation code: 32-42-00-610-801-01 park brake control cable (**511GC**)

2. LOGISTICS

A. References

Reference	Designation
• 20-35-02-910-802	GENERAL INSTRUCTIONS AND REPAIR APPLICABLE TO "TELEFORCE" FLEXIBLE CONTROL CABLES

B. Tools and Ground Support Equipment

Reference	Designation	Quantity
• F7XC202000008	TOOL BOX	
• TO-20-040	SPRING SCALE - CAPACITY 25 DAN (60 LBF)	

C. Ingredients and Consumable Products

Designation	Additional designation
• LOW FREEZE POINT GREASE	MIL-PRF-23827
• P-D-680B	WHITE SPIRIT
• LUBRICATING OIL	

D. Spare Parts

Reference	Designation	Quantity
• MS24665-155	SPLIT PIN	

E. Access

Reference	Designation
• 252CR	WING ROOT UPPER ACCESS DOOR
• PAX	PASSENGER DOOR

F. Miscellaneous

- CLEAN DRY CLOTH (LOCAL PROCUREMENT)

3. PRELIMINARY STEPS

Refer to **fig. 1**

- A. Remove door (**252CR**).

4. SERVICING

Refer to **fig. 1**

- A. Actuate park brake handle (**510GC**) and check that it operates smoothly and without hard point.

FALCON 900EX AIRCRAFT MAINTENANCE MANUAL

- B. Check first notch and second notch locking of park brake handle (510GC) for efficiency.
- C. Slowly actuate park brake handle (510GC):
 - (1) Clean the handle rod with a clean dry cloth.
 - (2) Clean the sliding rod of park brake flexible control (511GC) on park brake selector valve (30GC) side, through door (252CR).
- D. Clean the balljoint support using **P-D-680B**.
- E. Dry with a clean cloth.
- F. Lubricate indicated points with **low freeze point grease** or **lubricating oil**.

5. MEASUREMENT OF FLEXIBLE CONTROL SLIDING FORCES

Refer to **fig. 1**

- A. Actuate park brake handle (510GC) and measure, using a spring scale, the force required to actuate the control; this force must be < 14.5 daN (32.6 lbf) at the first notch and < 21 daN (47.2 lbf) at the second notch.
- B. If the measurements recorded are unsatisfactory, disconnect park brake flexible control (511GC) from park brake selector valve (30GC) as follows:
 - (1) Through door (252CR), remove:
 - split pin (4) and discard it,
 - nut (2),
 - washer (3),
 - pin (1).
 - (2) Actuate park brake handle (510GC) and measure, using a spring scale, the force required to actuate park brake flexible control (511GC); it must be < 1.4 daN (3.1 lbf).
 - (3) If the force required is greater, repair park brake control cable (511GC) (Refer to **TASK 20-35-02-910-802**).
 - (4) Connect park brake flexible control (511GC) to park brake selector valve (30GC) as follows:
 - (a) Through door (252CR):
 - install pin (1),
 - install washer (3) and nut (2),
 - tighten nut (2),
 - safety nut (2) with a new split pin (4) (**MS24665-155**).

6. FINAL STEPS

Refer to **fig. 1**

- A. Install door (252CR).

FALCON 900EX AIRCRAFT MAINTENANCE MANUAL

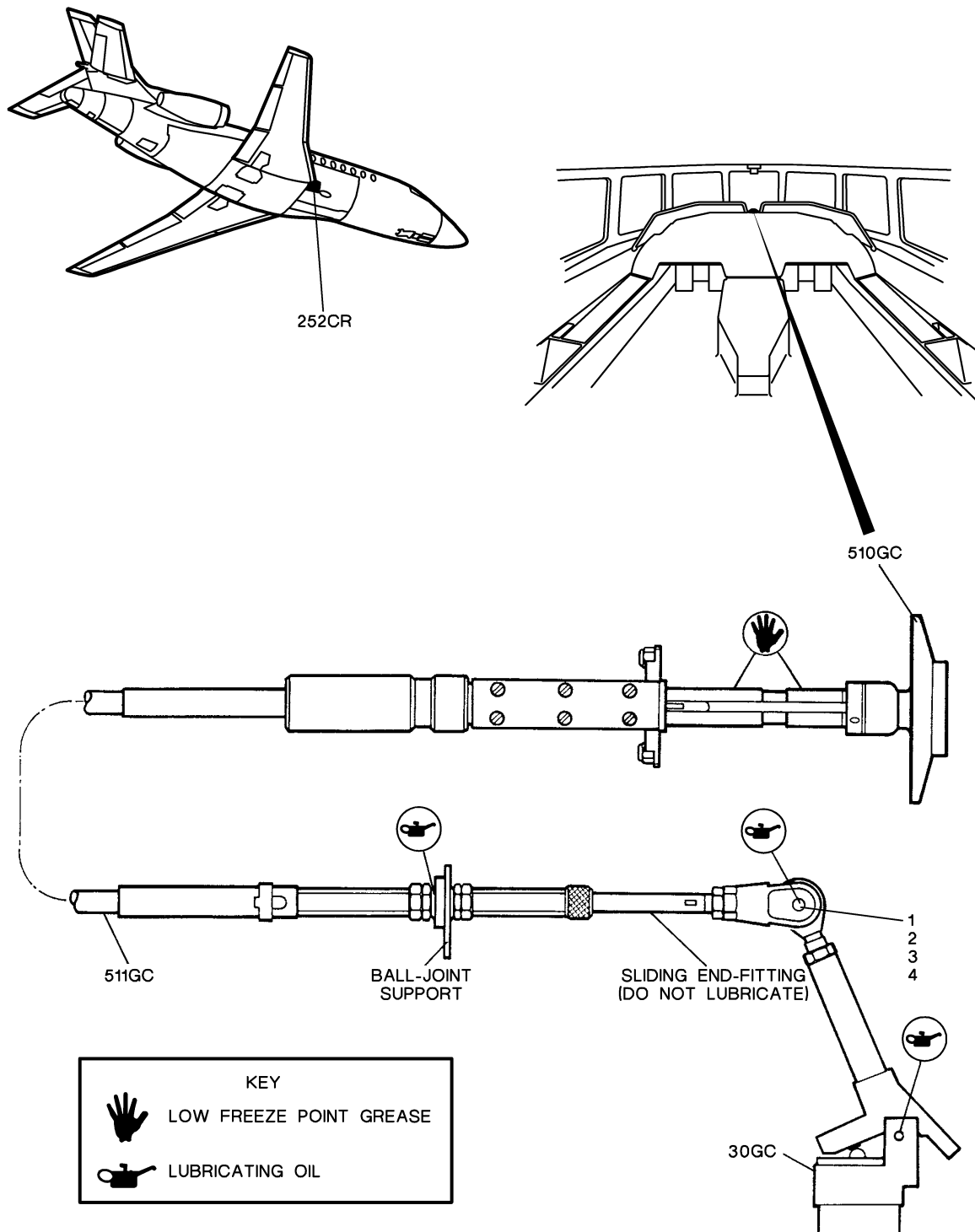

Figure 1: SERVICING OF THE PARK BRAKE CONTROL