

Project No: **BDHRN002**Job Card No **0058**

Notif.No.: 10049108

Activity: **1003**

Rev No: 20000622

Model.: F900EX

Sheet 1 of 1

A/C Regn: **D-AHRN**

Serial No.: 096

Type: F900EX

Starting Phase: Routine

Starting Work Centre: FALCON A/C TEAM

Job Description: **SERV WATER SYSTEM**

ETOPS A/C: No

RVSM A/C: No

Warranty: -

ATA: 38

Check Type: 2A+ Inspection

Work Center	
FALCON A/C	

**Zone: 200****Access Required for this task:**

BAG,PAX

## Corrective Action

0001

**Task carried out in accordance with the attached Customer Card that quotes the Operator code detailed below.**

Accomplished

Inspected

Pers. No.

Date

Pers. No.

Date

Stamp

Stamp

Order: 80069273

Operation: 0010

Phase: Routine - scheduling activity

Work Center:FALCON A/C TEAM

Completed &amp; Confirmed on SAP IAW MOE 2.13.

**Defect Card Raised**

## Components Removed/Installed

	Part Number	Part Name	S/N	Location	Comm. Off/On
OFF					
ON					
OFF					
ON					
OFF					
ON					
OFF					
ON					

Occurance Report Raised? YES ☐

Operations Above &amp; Notifications Completed IAW MOE 2.13.

OEM Code: 38-00-00-610-801

Operator Code: 38-00-00-610-801-01

Form No: JA-SAP-MTX-002

Printed by: ADAMOVIC G



Printed: 03.09.2012

13:34:17

Print No: 1

Operator: **HERON AVIATION**

Work Card No.: **38.070**

Serial No.: **096**

Model: **FALCON 900EX**

**PKG # 12 2A+ INSPECTION**

Reg No.: **D-AHRN**

Workorder No.: \_\_\_\_\_

	Date	A/C HRS	AFL	APH			
Due At	<b>25-NOV-2012</b>						
Accomplished							

TECHNICIAN SIGNATURE: \_\_\_\_\_ KIND OF CERTIFICATE & NO.: \_\_\_\_\_

INSPECTED BY: \_\_\_\_\_ KIND OF CERTIFICATE & NO.: \_\_\_\_\_

TECH	INSP	LABOR-HRS HRS.MINS
------	------	-----------------------

**>38-00-00-610-801- SERVICING OF THE WATER SYSTEM  
01**

REMARKS : \_\_\_\_\_

AMM 38-00-00-610-801

# FALCON 900EX AIRCRAFT MAINTENANCE MANUAL

## TASK 38-00-00-610-801 SERVICING OF THE WATER SYSTEM

**WARNING:** DURING THIS TEST, TAKE ALL REQUIRED PRECAUTIONS TO PREVENT HEAT-RELATED INJURIES TO PERSONNEL WORKING ON PRESSURIZATION COMPONENTS (LINES OR EQUIPMENT), PARTICULARLY AFTER APU RUN-UP.

**WARNING:** BE CAREFUL WHEN PERFORMING WORK WITH THE APU RUNNING. THE NOISE CAN CAUSE INJURIES TO PERSONNEL.

**CAUTION:** DURING THE REMOVAL OF THE INTERIOR COMPLETION, SEVERAL LINES OR COUPLINGS MAY HAVE TO BE DISCONNECTED TO FACILITATE THE REMOVAL OF PANELS.

**CAUTION:** AFTER DISCONNECTION/CONNECTION OF WATER SYSTEM COMPONENTS, TAKE ALL APPLICABLE PRECAUTIONS TO PREVENT WATER LEAKS, BEFORE INSTALLING THE INTERIOR COMPLETION.

### 1. OVERVIEW OF THE JOB

Operation code: 38-00-00-610-801-01

This procedure is to be used to check the integrity of the draining and pressurization components of the potable water system.

The steps in paragraph 8. "Leak Detection (if necessary)" are to be performed only if a fault is found in the potable water system.

**NOTE 1:** The location of components may vary depending on A/C completion. Refer to the Supplemental Maintenance Manual (SMM) for further information.

**NOTE 2:** The "Final Steps" are to be performed with the APU running.

Three operators are necessary to perform these steps:

- one operator in the cockpit,
- one operator near the CO2 fire extinguisher.
- one operator to check for leaks around the equipment to be tested.
  - this operator must use a ground mechanic's telephone to communicate with the operator in the cockpit.

**NOTE 3:** Two operators are necessary to perform the steps in paragraph "Servicing of Rear Lavatory Water System" and in paragraph "Servicing of Front Galley Water System":

- one operator near the front or the rear drain mast,
- one operator to run water in the front or the rear washbasin.

**NOTE 4:** The two drain containers placed under the front and the rear drain masts must not be removed until the end of the procedure.

### 2. LOGISTICS

#### A. References

##### Reference

- [20-00-00-910-801](#)

##### Designation

GENERAL MAINTENANCE AND SAFETY PRECAUTIONS

Effectivity: A/C ≥ 2

Rev. Date: MAR 09/2012

38-00-00-610-801

page 1 / 17

## FALCON 900EX AIRCRAFT MAINTENANCE MANUAL

• <a href="#">24-00-00-860-801</a>	ENERGIZATION / DE-ENERGIZATION OF THE AIRCRAFT
• <a href="#">38-10-00-610-801</a>	PRESSURE REFILLING OF THE POTABLE WATER SYSTEM
• <a href="#">38-10-00-610-802</a>	GRAVITY REFILLING OF THE POTABLE WATER SYSTEM
• <a href="#">38-13-01-960-801</a>	REPLACEMENT OF THE MAIN FILTER CARTRIDGE
• <a href="#">38-31-13-960-801</a>	REPLACEMENT OF THE GALLEY WATER FILTER
• <a href="#">38-40-17-900-801</a>	REMOVAL / INSTALLATION OF THE HIGH PRESSURE REGULATOR AIR FILTER ASSEMBLY
• <a href="#">38-40-21-900-801</a>	REMOVAL / INSTALLATION OF THE LOW PRESSURE REGULATOR AIR FILTER ASSEMBLY

### B. Tools and Ground Support Equipment

Reference	Designation	Quantity
• <a href="#">F7XC202000008</a>	TOOL BOX	

### C. Ingredients and Consumable Products

Designation	Additional designation
• <a href="#">LOCKWIRE</a>	MS20995C32
• <a href="#">BONDING RTV3145</a>	
• <a href="#">LEAK DETECTOR</a>	

### D. Spare Parts

Reference	Designation	Quantity
• <a href="#">3820-01</a>	FILTER	2 (A/C without SB F900EX-315)
• <a href="#">3820-01</a>	FILTER	1 (A/C with SB F900EX-315)

### E. Additional Spare Parts

Reference	Designation	Quantity
• <a href="#">MS29513-230</a>	O-RING	

### F. Energy

- ELECTRICAL
- PNEUMATIC

### G. Access

Reference	Designation
• <a href="#">PAX</a>	PASSENGER DOOR
• <a href="#">BAG</a>	BAGGAGE COMPARTMENT DOOR

### H. Miscellaneous

- SOURCE OF COMPRESSED AIR (15 BAR (218 PSI)) (LOCAL PROCUREMENT)
- DRAIN CONTAINER (LOCAL PROCUREMENT) (QTY : 2)
- CHOCK (LOCAL PROCUREMENT) (QTY : 2)
- CO2 FIRE EXTINGUISHER (LOCAL PROCUREMENT)
- GROUND MECHANIC'S TELEPHONE (LOCAL PROCUREMENT)
- LINT-FREE CLOTH (LOCAL PROCUREMENT)
- SPONGE (LOCAL PROCUREMENT)

## FALCON 900EX AIRCRAFT MAINTENANCE MANUAL

---

- PLUG (LOCAL PROCUREMENT)
- CONTAINER (LOCAL PROCUREMENT)

### 3. PRELIMINARY STEPS

Refer to **fig. 1** and **fig. 2**

- A. Obey the general maintenance and safety precautions (Refer to [TASK 20-00-00-910-801](#)).
- B. Energize the galley equipment with the electrical Ground Power Unit (GPU) (Refer to [TASK 24-00-00-860-801](#)).
- C. Make sure that the aircraft is parked on an area as flat as possible, to prevent the components to be tested from overflowing.
- D. Place a drain container under the front drain mast ([25HA](#)) and the rear drain mast ([23HA](#)).
- E. Check that the potable water tank is at least half-full, as follows:
  - (1) Press the "PUSH-TO-READ" pushbutton on the galley and check that the water quantity indicator reads "1/2".
  - (2) Release the "PUSH-TO-READ" pushbutton.
- F. If the tank is not half-full, fill the potable water system under pressure (Refer to [TASK 38-10-00-610-801](#)) or by gravity (Refer to [TASK 38-10-00-610-802](#)).
- G. De-energize the galley equipment (Refer to [TASK 24-00-00-860-801](#)).

### 4. REPLACEMENT OF THE FILTERING ELEMENTS OF THE HIGH PRESSURE REGULATOR / AIR FILTER ASSEMBLY ([600HU](#)) (A/C WITHOUT SB F900EX-315 ) AND LOW PRESSURE REGULATOR / AIR FILTER ASSEMBLY ([607HU](#))

Refer to **fig. 1**, **fig. 2**, **fig. 3** and **fig. 6**

**NOTE:** A/C without SB F900EX-315 are equipped with a high pressure regulator / air filter assembly ([600HU](#)) as illustrated in **fig. 3**.

A/C with SB F900EX-315 are equipped with a high pressure regulator / air filter assembly ([600HU](#)) as illustrated in **fig. 6**.

- A. Push the water tank gravity filling plug to fully de-pressurize the potable water system.

**NOTE:** Full de-pressurization of the system can be checked on the pressure gauge ([604HU](#)) located in the baggage compartment, and on the water tank pressure gauge ([609HU](#)) located behind the rear lavatory washbasin cabinet.

- B. Remove the low pressure regulator / air filter assembly ([607HU](#)) (Refer to [TASK 38-40-21-900-801](#)).

**CAUTION:** A/C WITH SB F900EX-315 : THE HIGH PRESSURE REGULATOR / AIR FILTER ASSEMBLY ([600HU](#)) DOES NOT INCLUDE ANY FILTERING ELEMENT. DO NOT REMOVE IT.

## FALCON 900EX AIRCRAFT MAINTENANCE MANUAL

---

- C. Remove the high pressure regulator / air filter assembly (**600HU**) (Refer to **TASK 38-40-17-900-801**) (A/C without SB F900EX-315 ).
- D. **Replace the filter** of the high pressure regulator / air filter assembly (**600HU**)(A/C without SB F900EX-315 ) **or** low pressure regulator / air filter assembly (**607HU**) as follows (**fig. 3**):
  - (1) Unscrew **the** bowl (1) of the high pressure regulator / air filter assembly (**600HU**)/low pressure regulator / air filter assembly (**607HU**).
  - (2) Remove **the** bowl (1) and **the** retain O-ring (2).
  - (3) Unscrew **the** filter (3) and extract it.
  - (4) Retain **the** screen (4) and **the** O-ring (5).
  - (5) Discard **the** filter (3).
  - (6) Apply a thin film of **bonding RTV3145** to **the** O-rings (2) and (5).
  - (7) **Install the O-ring (5) and the screen (4), then screw the new filter (3820-01).**
  - (8) Tighten the new filter to a torque of 0.5 to 1 m.N (4.42 to 8.85 in.lbf).
  - (9) Install **the** O-ring (2), then screw **the** bowl (1).
  - (10) Tighten **the** bowl (1) to a torque of 0.5 to 1 m.N (4.42 to 8.85 in.lbf).
- E. Install the low pressure regulator / air filter assembly (**607HU**) (Refer to **TASK 38-40-21-900-801**).
- F. Install the high pressure regulator / air filter assembly (**600HU**) (Refer to **TASK 38-40-17-900-801**) (A/C without SB F900EX-315 ).
- G. Set the "AIR SUPPLY" valve (**608HU**) to "OFF".
- H. Set the "CABIN WATER SUPPLY" valve (**531MD**) to "OFF".
- I. Remove the plug from the T-coupling (8) (**fig. 3**).
- J. Connect a source of compressed air to the T-coupling (8) (**fig. 3**).
- K. Slowly increase the pressure of the source of compressed air and check that the pressure, as read on pressure gauge (**604HU**), is between 105 and 120 psi.
- L. If the pressure is not between 105 and 120 psi:
  - (1) For A/C without SB F900EX-315 :
    - Adjust the regulated pressure (Refer to **TASK 38-40-17-900-801**), paragraph "**Adjustment**".
  - (2) For A/C with SB F900EX-315 :
    - Replace the high pressure regulator / air filter assembly (**600HU**) (Refer to **TASK 38-40-17-900-801**).
- M. Check for leaks at the couplings of the high pressure regulator / air filter assembly (**600HU**), using **leak detector**.

## FALCON 900EX AIRCRAFT MAINTENANCE MANUAL

---

- N. Wipe off the leak detector with a lint-free cloth.
- O. Set the "AIR SUPPLY" valve (608HU) to "ON".
- P. On the vanity, check that the pressure reading on the "WATER TANK PRESSURE" gauge (609HU) is between 25 and 30 psi.
- Q. If the pressure is not between 25 and 30 psi:
  - Adjust the regulated pressure (Refer to TASK 38-40-21-900-801), paragraph "Test and Adjustment".
- R. Check for leaks at the couplings of the low pressure regulator / air filter assembly (607HU), using leak detector.
- S. Wipe off the leak detector with a lint-free cloth.
- T. Drop the pressure of the source of compressed air.
- U. Disconnect the source of compressed air from the T-coupling (8) (**fig. 3**).
- V. Install the plug on the T-coupling (8) (**fig. 3**).

### 5. SERVICING OF DRAINING AND PRESSURIZATION SYSTEMS

Refer to **fig. 1**, **fig. 2**, **fig. 4** and **fig. 5**

- A. Check the pressure-relief valves (603HU)/(606HU) as follows:
  - (1) Connect a source of compressed air to the charging valve (602HU).
  - (2) Set the "AIR SUPPLY" valve (608HU) to "OFF".
  - (3) Slowly increase the pressure of the source of compressed air and check that the pressure-relief valves (603HU)/(606HU) open at a pressure of 8.65 bar (125.5 psi).
  - (4) If they do not, replace the faulty pressure-relief valve as follows:
    - (a) Drop the pressure of the source of compressed air.
    - (b) Push the water tank gravity filling plug to fully de-pressurize the potable water tank.  
NOTE: Full de-pressurization can be checked on the "WATER TANK PRESSURE" gauge (609HU) located behind the rear lavatory washbasin cabinet.
    - (c) Remove the water tank gravity filling plug by rotating it counterclockwise.  
NOTE: A red indicator shows on the water tank gravity filling plug when it is unlocked.
    - (d) Slowly set the "AIR SUPPLY" valve (608HU) to "ON" and wait for full de-pressurization of the system, as read on pressure gauge (604HU) located in the baggage compartment.
    - (e) Install the water tank gravity filling plug by rotating it clockwise.  
NOTE: A green indicator shows on the water tank gravity filling plug when it is locked.
    - (f) Replace the faulty pressure-relief valve.
    - (g) Continue the procedure from paragraph 5.A.

## FALCON 900EX AIRCRAFT MAINTENANCE MANUAL

---

(5) Drop the pressure of the source of compressed air.

(6) Disconnect the source of compressed air from the charging valve (602HU).

B. Replace the cartridge of water filter (506MD) (Refer to [TASK 38-13-01-960-801](#)).

NOTE: Rinse the filter with fresh water before installing it.

C. Replace the front galley filter (Refer to [TASK 38-31-13-960-801](#)) (if any).

D. For A/C with rear washbasin decanting filter (519MD) (fig. 5), clean it as follows:

NOTE: A/C equipped with a rear washbasin decanting filter (519MD) (fig. 5) have no rear diaphragm drain valve (520MD) (fig. 3).

(1) Removal

(a) Remove the clamp (7) from the line (6).

(b) Disconnect the line (6).

(c) Remove the lockwire (10) from the two tension latches (11).

(d) Open the two tension latches (11).

(e) Remove the clamp (8) from the rear washbasin decanting filter (519MD).

(f) Remove the rear washbasin decanting filter (519MD).

(2) Clean the rear washbasin decanting filter (519MD) with fresh water.

(3) Installation

(a) Position the rear washbasin decanting filter (519MD).

NOTE: If the O-ring (12) has to be replaced, secure the new O-ring ([MS29513-230](#)) to the base with **bonding RTV3145**.

(b) Install the two tension latches (11).

(c) Install the clamp (8) of the rear washbasin decanting filter (519MD).

(d) Connect the line (6).

(e) Install the clamp (7) of the line (6).

(f) Check for leaks by pouring water into the rear washbasin.

(g) Safety the two tension latches (11) with **lockwire** (10).

E. For A/C with a rear diaphragm drain valve (520MD) (fig. 3), check it as follows:

NOTE: A/C equipped with a rear diaphragm drain valve (520MD) (fig. 3) have no rear washbasin decanting filter (519MD) (fig. 5).

(1) Check for any cracks.

(2) Run potable water into the rear washbasin.

(3) Check for leaks at the inlet (14) of the diaphragm drain valve (520MD).



## FALCON 900EX AIRCRAFT MAINTENANCE MANUAL

---

- (4) Run potable water into the rear washbasin until the diaphragm drain valve (**520MD**) opens.
- (5) Check for leaks at the outlet (15) of the diaphragm drain valve (**520MD**).
- (6) Pull up the ring (13) located at the top of the diaphragm drain valve (**520MD**) to eliminate any residual water.

F. Repeat the steps of paragraph 5.E. for the front diaphragm drain valve.

### **6. SERVICING OF REAR LAVATORY WATER SYSTEM**

Refer to **fig. 1**, **fig. 2**, **fig. 3** and **fig. 4**

- A. Blank the rear drain mast (**23HA**) with a plug.
  - B. Set the "CABIN WATER SUPPLY" valve (**531MD**) to "OFF".
  - C. Check the connections of components (filters, faucets, valves and potable water tank) and the water lines for condition.
  - D. In the rear lavatory, close the washbasin drain plug.
  - E. Using a container, pour water into the washbasin until water flows over through the overflow port.
  - F. Check for leaks at the couplings of the overflow port line.
  - G. In the rear lavatory, open the washbasin drain plug.
  - H. Open the rear washbasin hot, then cold mixer faucets (**507MD**) until water flows out, and wait for 20 seconds.
  - I. Close the rear washbasin hot and cold mixer faucets (**507MD**).
  - J. Check for leaks at all the couplings of the vanity.
  - K. Set the "OVERBOARD DRAIN" valve (**509MD**) to "DRAIN".
  - L. Check for traces of water under the rear lavatory water system.
  - M. Check for leaks at the couplings of the "DRAIN/OVERBOARD DRAIN" valve (**509MD**).
- NOTE:** If a leak is found, refer to paragraph 8.A. "If a leak is found in the rear lavatory water system".
- N. Set the "OVERBOARD DRAIN" valve (**509MD**) to "OFF".
  - O. Remove the plug from the rear drain mast (**23HA**).
  - P. Check that the water is correctly drained through the rear drain mast (**23HA**).
  - Q. If not, check for leaks at the coupling between the "DRAIN/OVERBOARD DRAIN" valve (**509MD**) and the rear drain mast (**23HA**).

## FALCON 900EX AIRCRAFT MAINTENANCE MANUAL

**NOTE:** If a leak is found, refer to paragraph 8.A. "If a leak is found in the rear lavatory water system".

- R. Pull up the ring (13) located at the top of the diaphragm drain valve (**520MD**) to eliminate any residual water (**fig. 4**).

### 7. **SERVICING OF FRONT GALLEY WATER SYSTEM**

Refer to **fig. 1** and **fig. 2**

- A. Blank the front drain mast (**25HA**) with a plug.
- B. In the galley, remove the ice drawer.
- C. Set the "CABIN WATER SUPPLY" valve (**531MD**) to "ON".
- D. Set the "VANITY WATER SUPPLY" valve (**505MD**) to "OFF".
- E. Check the connections of components (filter, faucets, valve) and the water lines for condition.
- F. Check for leaks in the front water system between the "CABIN WATER SUPPLY" valve (**531MD**) and the front galley.

**NOTE:** If a leak is found, refer to paragraph 8.B. "If a leak is found in the front galley water system".

- G. Open the following faucets until water flows out, and wait for 20 seconds:

- (1) The galley mixer faucet (**527MD**).
- (2) The front washbasin mixer faucet (**521MD**).

- H. Close the faucets:

- (1) The galley mixer faucet (**527MD**).
- (2) The front washbasin mixer faucet (**521MD**).

- I. Run approximately 0.5 l (0.13 USG) of potable water into the ice drawer receptacle.

- J. Check for traces of water under the galley water system.

- K. Check for leaks at all the couplings in the galley and at the ice drawer receptacle.

**NOTE:** If a leak is found, refer to paragraph 8.B. "If a leak is found in the front galley water system".

- L. Remove the plug from the front drain mast (**25HA**).

- M. Check that the water is correctly drained through the front drain mast (**25HA**).

- N. If not, check for leaks at the upstream coupling of the front drain mast (**25HA**).

**NOTE:** If a leak is found, refer to paragraph 8.B. "If a leak is found in the front galley water system".

## FALCON 900EX AIRCRAFT MAINTENANCE MANUAL

---

- O. Wipe off the residual water in the ice drawer receptacle with a sponge and a cloth, if necessary.
- P. Install the ice drawer.
- Q. Pull up the ring located at the top of the front diaphragm drain valve to eliminate any residual water.
- R. Set the "VANITY WATER SUPPLY" valve (505MD) to "ON".

### 8. LEAK DETECTION (IF NECESSARY)

Refer to **fig. 1** and **fig. 2**

A. If a leak is found in the rear lavatory water system:

(1) Drain the rear lavatory water system as follows:

(a) Set the "OVERBOARD DRAIN" valve (509MD) to "DRAIN".

If the pressure in the potable water tank (500MD) drops to zero, as read on the "WATER TANK PRESSURE" gauge (609HU), open the water tank gravity filling plug located under the soap holder in the rear lavatory:

- Push the water tank gravity filling plug and rotate it counterclockwise to open it.

NOTE: A red indicator shows on the water tank gravity filling plug when it is unlocked.

(b) When water stops flowing from the rear drain mast (23HA), set the "OVERBOARD DRAIN" valve (509MD) to "OFF".

(c) Close the water tank gravity filling plug by rotating it clockwise.

NOTE: A green indicator shows on the water tank gravity filling plug when it is locked.

(d) Open the rear washbasin mixer faucet (507MD) in the rear lavatory until water flows out.

If the pressure in the potable water tank (500MD) drops to zero, as read on the "WATER TANK PRESSURE" gauge (609HU), connect a source of compressed air to the charging valve (602HU).

(e) When water stops flowing, close the rear washbasin mixer faucet (507MD).

(2) Repair the water system.

(3) Fill the potable water system under pressure (Refer to **TASK 38-10-00-610-801**) or by gravity (Refer to **TASK 38-10-00-610-802**).

(4) Wait half an hour and check that the pressure reading on the "WATER TANK PRESSURE" gauge (609HU) remains unchanged.

(5) Repeat the procedure from paragraph 6. "Servicing of Rear Lavatory Water System".

B. If a leak is found in the front galley water system:

(1) Drain the front galley water system as follows:

(a) Open and keep the following faucets open until water stops flowing:

1 The galley mixer faucet (527MD),

2 The front washbasin mixer faucet (521MD).

(b) Close the faucets:

## FALCON 900EX AIRCRAFT MAINTENANCE MANUAL

---

- 1 The galley mixer faucet (**527MD**),
  - 2 The front washbasin mixer faucet (**521MD**).
- (2) Repair the water system.
  - (3) Fill the potable water system under pressure (Refer to **TASK 38-10-00-610-801**) or by gravity (Refer to **TASK 38-10-00-610-802**).
  - (4) Wait half an hour and check that the pressure reading on the pressure gauge (**604HU**) remains unchanged.
  - (5) Repeat the procedure from paragraph 7. "Servicing of Front Galley Water System".

### **9. UNBLOCKING THE PAN DRAIN (IF NECESSARY)**

Refer to **fig. 4**

- A. Wipe off all the water left in the pan (1) with a sponge.
- B. Disconnect the coupling (2).
- C. Blow compressed air through the pan drain to unblock it.
- D. Connect the coupling (2).
- E. Run potable water into the pan (1) and make sure that the water flows out through the pan drain line (4), without any leakage.
- F. Wipe off the residual water with a sponge and a cloth.

### **10. FINAL STEPS**

Refer to **fig. 2** and **fig. 3**

- A. Fill up the potable water tank (**500MD**), as necessary (Refer to **TASK 38-10-00-610-801**) or (Refer to **TASK 38-10-00-610-802**).
- B. Remove and empty the two drain containers.
- C. Check that the following valves are set to "ON":
  - "AIR SUPPLY" valve (**608HU**),
  - "VANITY WATER SUPPLY" valve (**505MD**),
  - "CABIN WATER SUPPLY" valve (**531MD**).
- D. Make sure that the wheel chocks are in position.
- E. Make sure that a CO2 fire extinguisher is ready at hand near the aircraft.
- F. Connect the ground mechanic's telephone.
- G. Start the APU (see the Airplane Flight Manual).

**WARNING: SERIOUS BURNS CAN RESULT FROM CONTACT WITH HOT LINES IN THIS AREA.**

## FALCON 900EX AIRCRAFT MAINTENANCE MANUAL

---

- H. Check for leaks at the T-coupling (8) ( **fig. 3**), using leak detector.
- I. Wipe off the leak detector with a lint-free cloth.
- J. On the galley, press the "PUSH-TO-READ" pushbutton and record the water level in the potable water tank.
- K. Check that the pressure reading on the pressure gauge (**604HU**) is approximately 20 psi (1.4 bar).
- L. Shut down the APU (see the Airplane Flight Manual).
- M. Disconnect the ground mechanic's telephone.
- N. Wait half an hour, then press the "PUSH-TO-READ" pushbutton on the galley and check that the water level in the potable water tank remains unchanged.  
If the water level has decreased, refer to paragraph 8. "Leak Detection (if necessary)".

## FALCON 900EX AIRCRAFT MAINTENANCE MANUAL

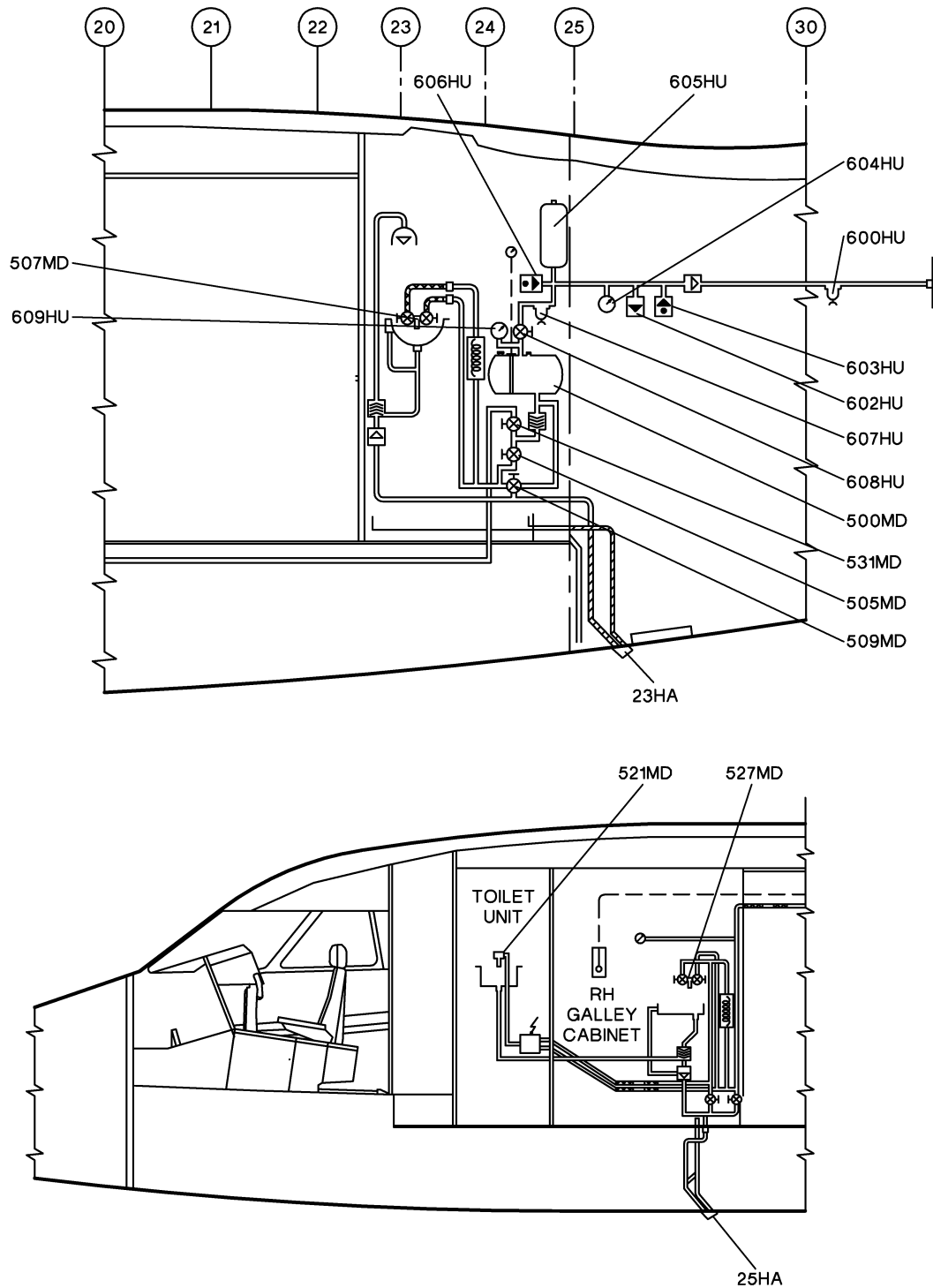

**Figure 1: WATER SYSTEM - PRINCIPLE DIAGRAM**

## FALCON 900EX AIRCRAFT MAINTENANCE MANUAL

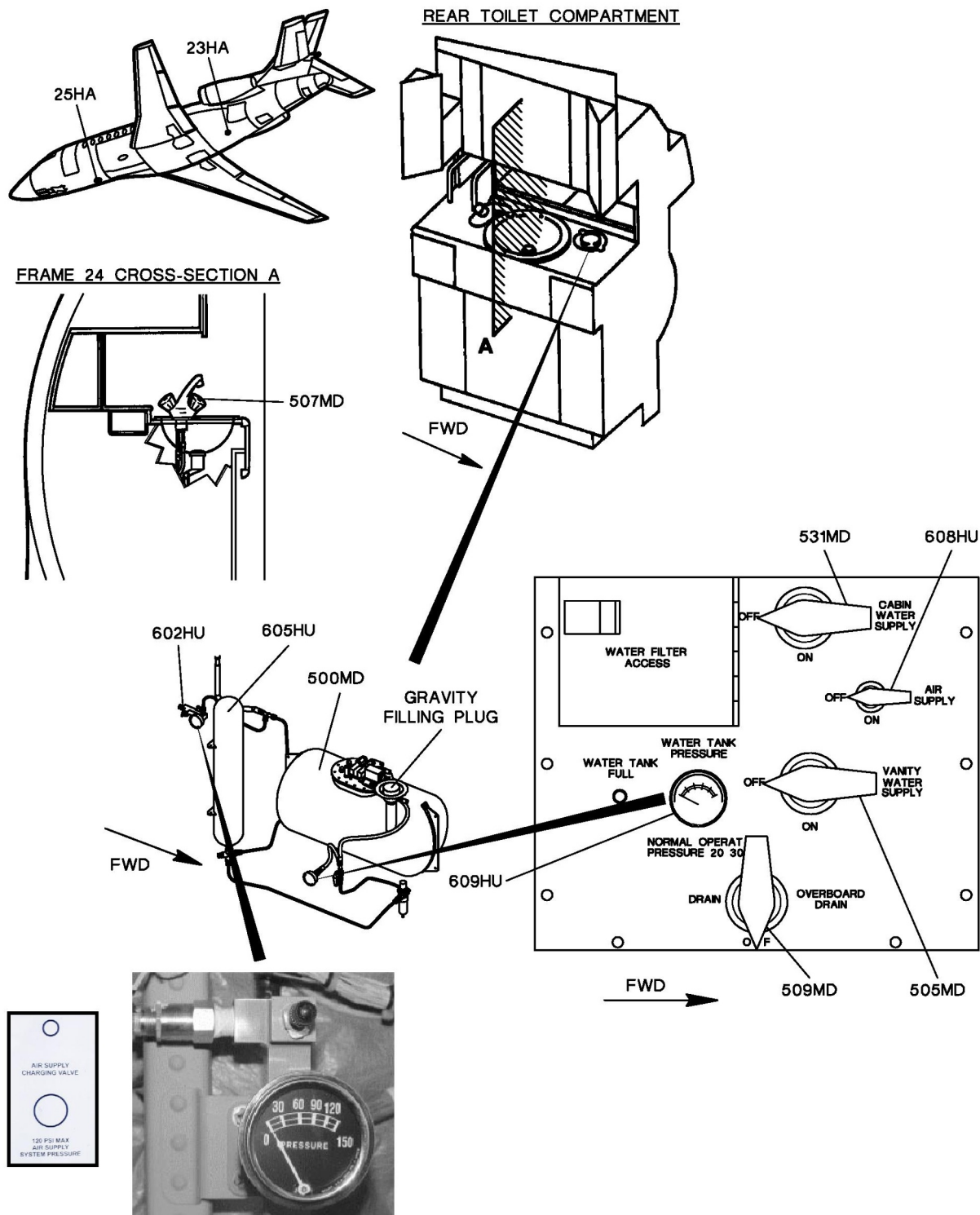

**Figure 2: POTABLE WATER SYSTEM CONTROLS**

## FALCON 900EX AIRCRAFT MAINTENANCE MANUAL

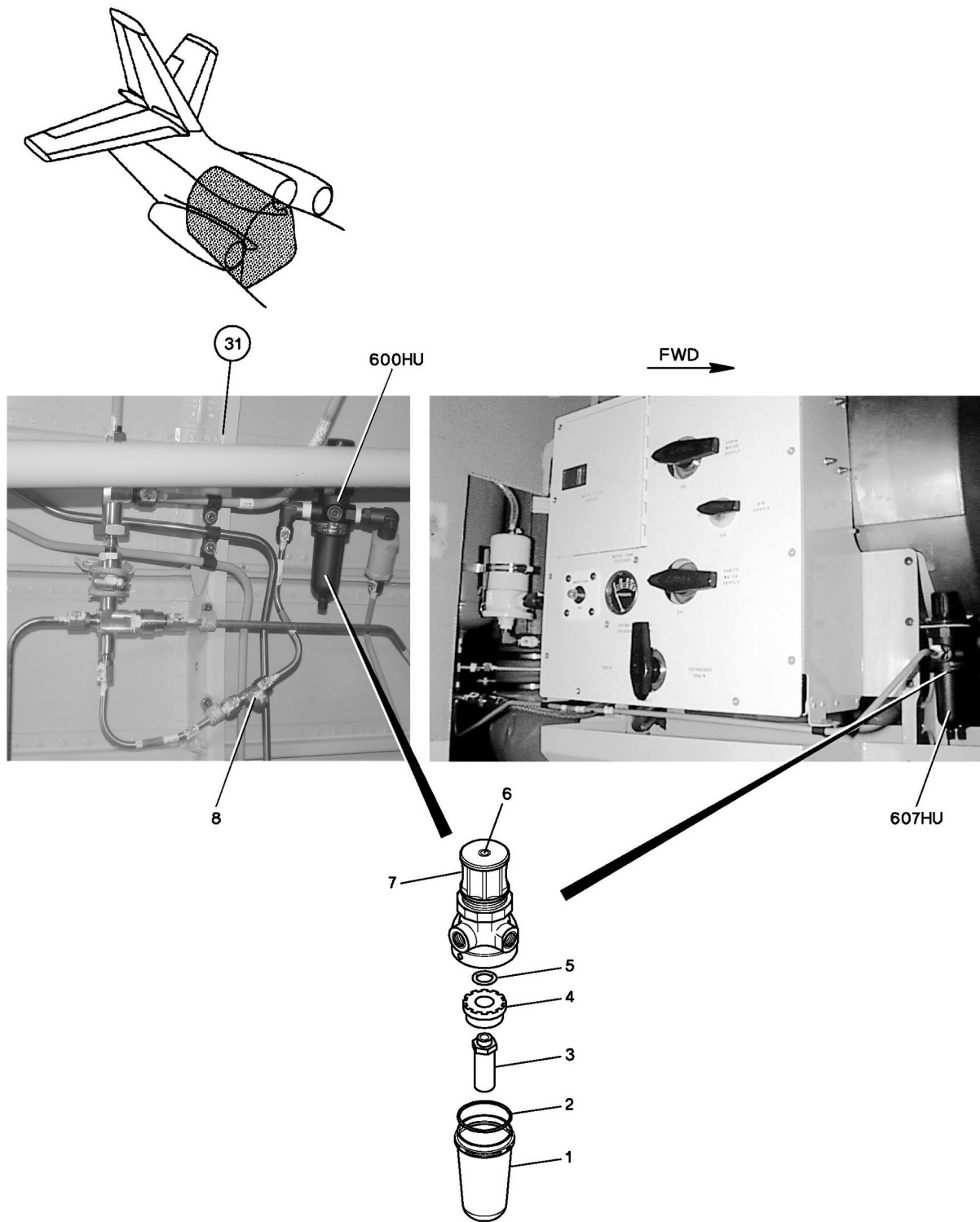

**Figure 3: LOCATION OF HIGH-PRESSURE REGULATOR/AIR FILTER ASSEMBLY (A/C WITHOUT SB F900EX-315) AND LOW-PRESSURE REGULATOR/AIR FILTER ASSEMBLY**



## FALCON 900EX AIRCRAFT MAINTENANCE MANUAL

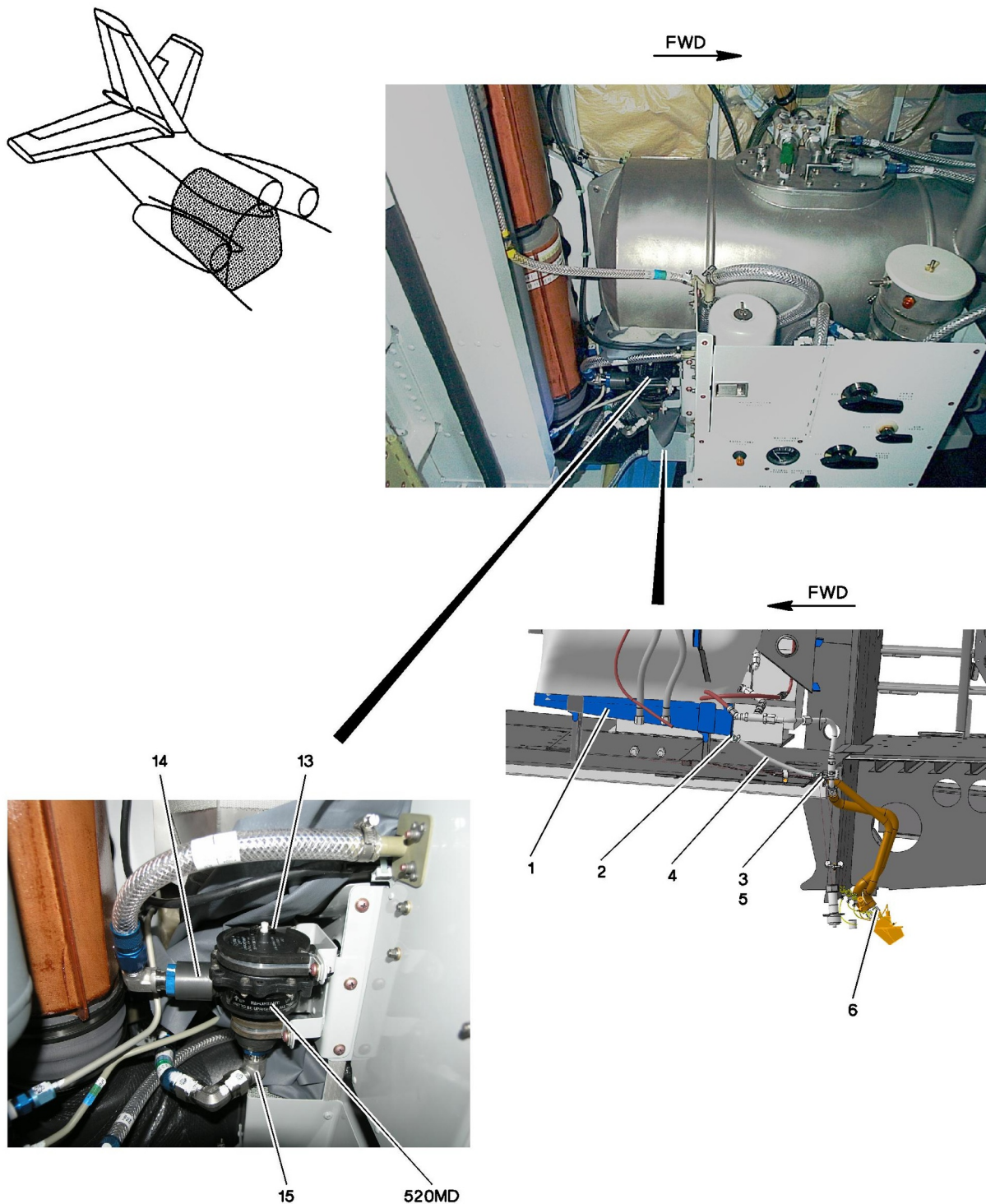

**Figure 4: DIAPHRAGM DRAIN VALVE AND PAN DRAIN LINE**

## FALCON 900EX AIRCRAFT MAINTENANCE MANUAL

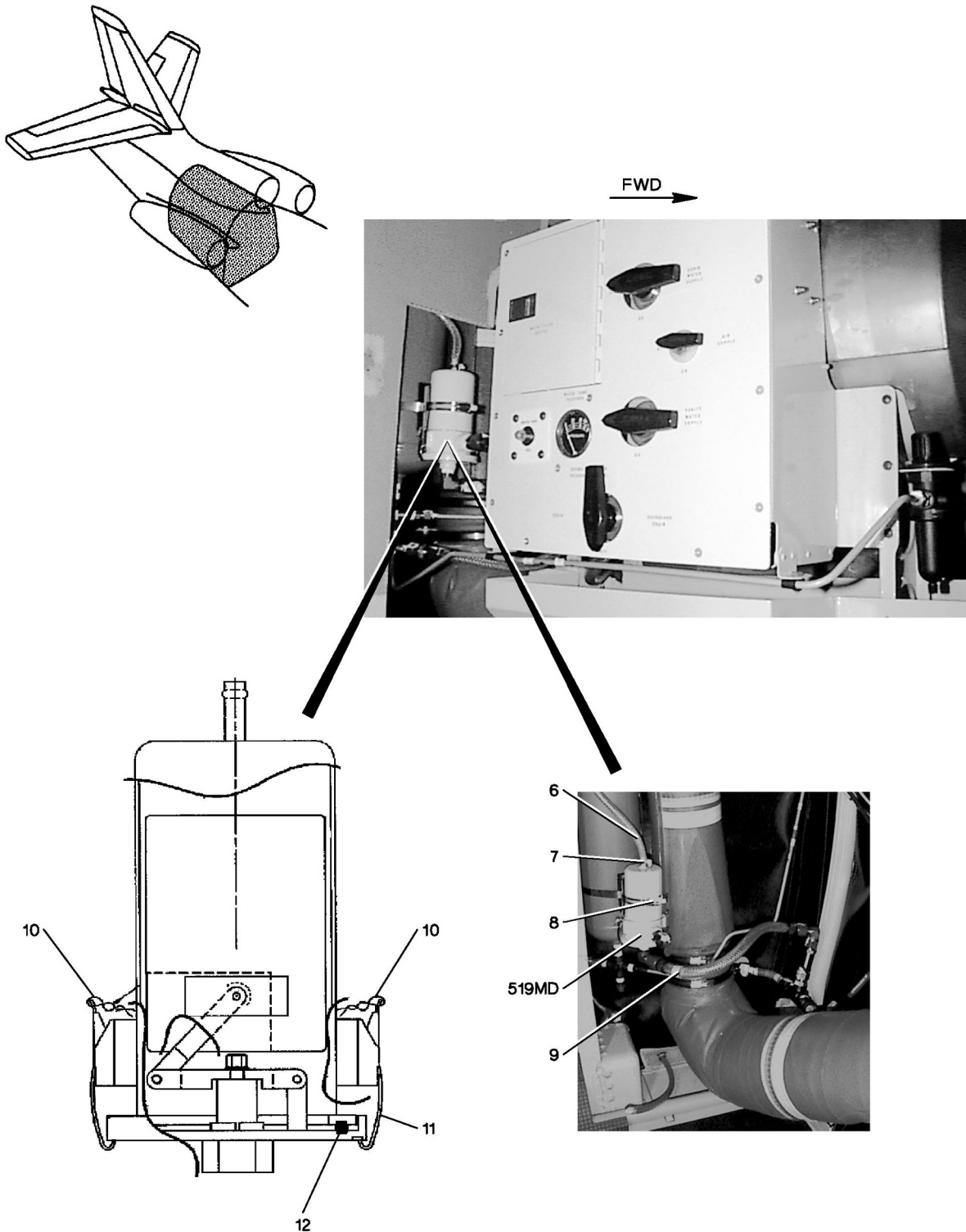

**Figure 5: REAR WASHBASIN DECANTING FILTER**

## FALCON 900EX AIRCRAFT MAINTENANCE MANUAL

---

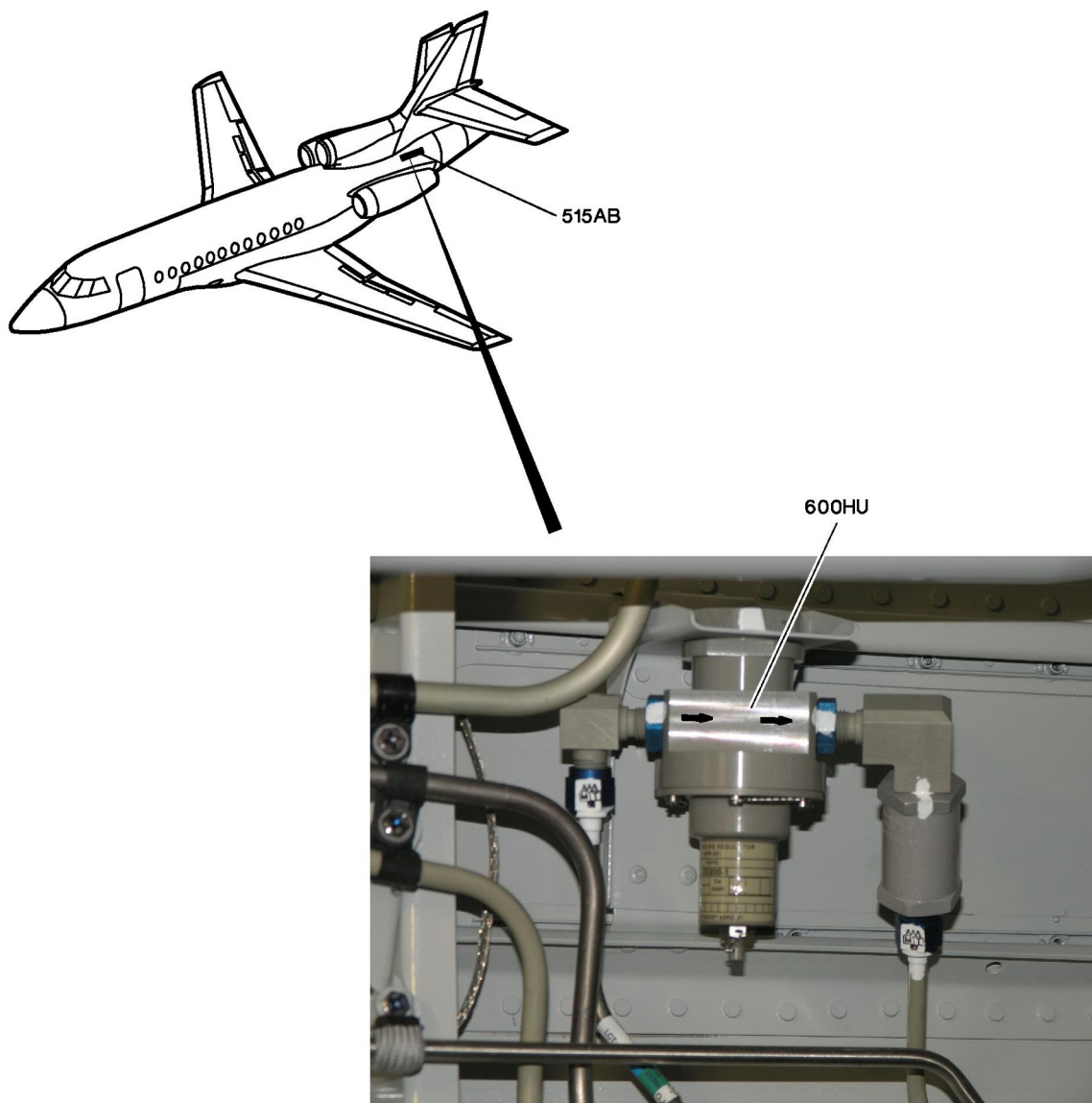

**Figure 6: LOCATION OF HIGH-PRESSURE REGULATOR/AIR FILTER ASSEMBLY (A/C WITH SB F900EX-315)**