

Project No: **BDHRN002**Job Card No **0105**

Notif.No.: 10049054

Activity: **1001**

Rev No: 20000622

Model.: F900EX

Sheet 1 of 1

A/C Regn: **D-AHRN**

Serial No.: 096

Type: F900EX

Starting Phase: Routine

Starting Work Centre: FALCON A/C TEAM

Job Description: **LUB Flap Rollers&Tracks**

ETOPS A/C: No RVSM A/C: No Warranty: - ATA: 57

Check Type: 2A CHECK

Work Center	
FALCON A/C	

Zone: 500,600**Access Required for this task:**

563AB,563BB,563DB,563EB,574AB,574BB,574DB,663AB,663BB,663DB,663EB,674AB,674BB,674DB

Corrective Action

0001	Task carried out in accordance with the attached Customer Card that quotes the Operator code detailed below.					 Order: 80069210 Operation: 0010 Phase: Routine - scheduling activity Work Center:FALCON A/C TEAM
	Accomplished		Inspected			
	Pers. No.	Date	Pers. No.	Date		
	Stamp		Stamp			

Completed & Confirmed on SAP IAW MOE 2.13.

Defect Card Raised

Components Removed/Installed

	Part Number	Part Name	S/N	Location	Comm. Off/On
OFF					
ON					
OFF					
ON					
OFF					
ON					
OFF					
ON					

Occurance Report Raised? YES ☐

Operations Above & Notifications Completed IAW MOE 2.13.

OEM Code: 57-55-13-640-801

Operator Code: 57-55-13-640-801-02

Form No: JA-SAP-MTX-002

Printed by: ADAMOVIC G



Printed: 03.09.2012

13:34:17

Print No: 1

Operator: **HERON AVIATION**

Work Card No.: **57-55-13-640-801-02**

Serial No.: **096**

Model: **FALCON 900EX**

PKG # 2 2A INSPECTION

Reg No.: **D-AHRN**

Workorder No.: _____

	Date	A/C HRS	AFL	APH			
Due At	25-NOV-2012	4410:47					
Accomplished							

TECHNICIAN SIGNATURE: _____ KIND OF CERTIFICATE & NO.: _____

INSPECTED BY: _____ KIND OF CERTIFICATE & NO.: _____

TECH	INSP	LABOR-HRS HRS.MINS
------	------	-----------------------

>57-55-13-640-801-02 GREASING/LUBRICATION OF THE RIGHT WING FLAP ROLLERS AND TRACKS

REMARKS : _____

AMM 57-55-13-640-801 TO BE PERFORMED AFER FLYING THROUGH SAND OR VOLCANIC ASH.

FALCON 900EX AIRCRAFT MAINTENANCE MANUAL

TASK 57-55-13-640-801

GREASING / LUBRICATION OF FLAP ROLLERS AND TRACKS

1. OVERVIEW OF THE JOB

Operation codes:

- 57-55-13-640-801-01 LH wing
- 57-55-13-640-801-02 RH wing

2. LOGISTICS

A. References

Reference	Designation
• <u>24-00-00-860-801</u>	ENERGIZATION / DE-ENERGIZATION OF THE AIRCRAFT
• <u>27-00-00-910-801</u>	FLIGHT CONTROL SYSTEM MAINTENANCE AND SAFETY PRECAUTIONS
• <u>27-50-00-860-802</u>	EXTENSION / RETRACTION OF THE SLATS / FLAPS FOR MAINTENANCE
• <u>29-00-00-860-801</u>	PRESSURIZATION / DE-PRESSURIZATION OF THE HYDRAULIC SYSTEMS

B. Tools and Ground Support Equipment

Reference	Designation	Quantity
• <u>F7XC202000008</u>	TOOL BOX	
• <u>TF50B27002A1</u>	GREASING ADAPTER FOR FLAP ROLLERS	

C. Ingredients and Consumable Products

Designation	Additional designation
• <u>P-D-680B</u>	WHITE SPIRIT
• <u>LUBRICATING OIL</u>	
• <u>SYNTHETIC GREASE</u>	MIL-PRF-81322

D. Energy

- ELECTRICAL
- HYDRAULIC

E. Access

Reference	Designation
• <u>563AB</u>	INBOARD FLAP LOWER SURFACE ACCESS DOOR
• <u>563BB</u>	INBOARD FLAP LOWER SURFACE ACCESS DOOR
• <u>563DB</u>	INBOARD FLAP LOWER SURFACE ACCESS DOOR
• <u>563EB</u>	INBOARD FLAP LOWER SURFACE ACCESS DOOR
• <u>574AB</u>	OUTBOARD FLAP LOWER SURFACE ACCESS DOOR
• <u>574BB</u>	OUTBOARD FLAP LOWER SURFACE ACCESS DOOR
• <u>574DB</u>	OUTBOARD FLAP LOWER SURFACE ACCESS DOOR
• <u>663AB</u>	INBOARD FLAP LOWER SURFACE ACCESS DOOR

FALCON 900EX AIRCRAFT MAINTENANCE MANUAL

- **663BB** INBOARD FLAP LOWER SURFACE ACCESS DOOR
- **663DB** INBOARD FLAP LOWER SURFACE ACCESS DOOR
- **663EB** INBOARD FLAP LOWER SURFACE ACCESS DOOR
- **674AB** OUTBOARD FLAP LOWER SURFACE ACCESS DOOR
- **674BB** OUTBOARD FLAP LOWER SURFACE ACCESS DOOR
- **674DB** OUTBOARD FLAP LOWER SURFACE ACCESS DOOR

3. PRELIMINARY STEPS

- A. Obey the Flight Control System maintenance and safety precautions (Refer to **TASK 27-00-00-910-801**).
- B. Remove track fairings and access doors (**563AB**), (**563BB**), (**563DB**), (**563EB**), (**574AB**), (**574BB**), (**574DB**) from the LH wing .
- C. Remove track fairings and access doors (**663AB**), (**663BB**), (**663DB**), (**663EB**), (**674AB**), (**674BB**) and (**674DB**) from the RH wing .
- D. Connect the electrical ground power unit (GPU) (Refer to **TASK 24-00-00-860-801**).
- E. Connect the hydraulic GPU to hydraulic system 2 (Refer to **TASK 29-00-00-860-801**).
- F. Full extension of flaps
 - (1) Energize the aircraft systems with the electrical GPU (Refer to **TASK 24-00-00-860-801**).
 - (2) Pressurize hydraulic system 2 from the hydraulic GPU (Refer to **TASK 29-00-00-860-801**).
 - (3) Fully extend the flaps alone (Refer to **TASK 27-50-00-860-802**).
 - (4) Cut off and drop the pressure in hydraulic system 2 from the hydraulic GPU (Refer to **TASK 29-00-00-860-801**).

NOTE: The slats can move if the pressure in hydraulic systems is not completely dropped.

 - (5) De-energize the aircraft systems (Refer to **TASK 24-00-00-860-801**).
- G. Inhibit the flap and slat deflections (Refer to **TASK 27-50-00-860-802**, paragraph "Operation on Slats and/or Flaps Extended").

4. CLEANING

Refer to **fig. 1**

- A. Using clean lint-free clothes, moistened with white spirit **P-D-680B**, clean the flap tracks (from track 1 to track 6).

5. GREASING/LUBRICATION

Refer to **fig. 1** and **fig. 2**

CAUTION: THE LUBRICATION OF CONTROL CABLE AND CABLE LUG OF FLAP POSITION POTENTIOMETERS (**L4DL**) AND (**R4DL**) IS PROHIBITED.

FALCON 900EX AIRCRAFT MAINTENANCE MANUAL

A. Greasing of inboard flap rollers

NOTE: To grease the inboard flap rollers with greasing adapter (**TF50B27002A1**), it may be necessary to remove the spacers (2-fig. 2).

- (1) Remove the grease nipples (1-fig. 2) from spacers (2-fig. 2).
- (2) Remove the spacers (2-fig. 2) from the roller assemblies.
- (3) Install the grease nipples (1-fig. 2) directly on the roller assemblies.
- (4) Using greasing adapter for flap rollers (**TF50B27002A1**), grease the inboard flap rollers (see **fig. 1**, items 7 to 12) with **synthetic grease**.
- (5) Remove the grease nipples (1-fig. 2) from the roller assemblies.
- (6) Install the spacers (2-fig. 2) on the roller assemblies.
- (7) Position the grease nipples (1-fig. 2) on the spacers (2-fig. 2).
- (8) Screw the grease nipples (1-fig. 2) by hand until one or two threads maximum remain visible.
- (9) Tighten the grease nipples (1-fig. 2) by 3/4th turn.

B. Greasing of outboard flap rollers

Using greasing adapter for flap rollers (**TF50B27002A1**), grease the outboard flap rollers (see **fig. 1**, items 1 to 6) with **synthetic grease**.

C. Lubrication of flap tracks

Using a cloth moistened with **lubricating oil**, lubricate the flap tracks (from track 1 to track 6).

6. FINAL STEPS

A. Remove the flap and slat safeties (Refer to **TASK 27-50-00-860-802**, paragraph "Operation on Slat and/or Flaps Extended").

B. Full retraction of flaps

- (1) Energize the aircraft systems with the Electrical GPU (Refer to **TASK 24-00-00-860-801**).
- (2) Pressurize hydraulic system 2 from the Hydraulic GPU (Refer to **TASK 29-00-00-860-801**).
- (3) Fully retract the flaps alone (Refer to **TASK 27-50-00-860-802**).
- (4) Cut off and drop the pressure in hydraulic system 2 from the hydraulic GPU (Refer to **TASK 29-00-00-860-801**).
- (5) De-energize the aircraft systems (Refer to **TASK 24-00-00-860-801**).

C. Disconnect the hydraulic GPU (Refer to **TASK 29-00-00-860-801**).

D. Disconnect the electrical GPU (Refer to **TASK 24-00-00-860-801**).

E. Install track fairings and access doors (**563AB**), (**563BB**), (**563DB**), (**563EB**), (**574AB**), (**574BB**), (**574DB**), on the LH wing.

FALCON 900EX AIRCRAFT MAINTENANCE MANUAL

- F. Install track fairings and access doors **(663AB)**, **(663BB)**, **(663DB)**, **(663EB)**, **(674AB)**, **(674BB)** and **(674DB)**, on the RH wing.

FALCON 900EX AIRCRAFT MAINTENANCE MANUAL

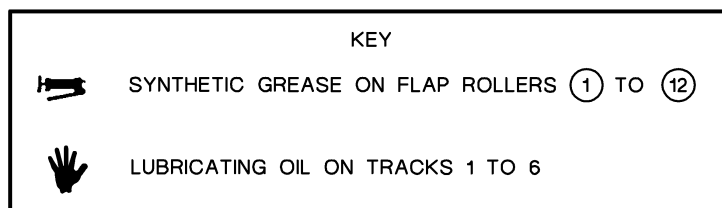

NOTE: LH WING ONLY IS ILLUSTRATED (SAME FOR RH WING)

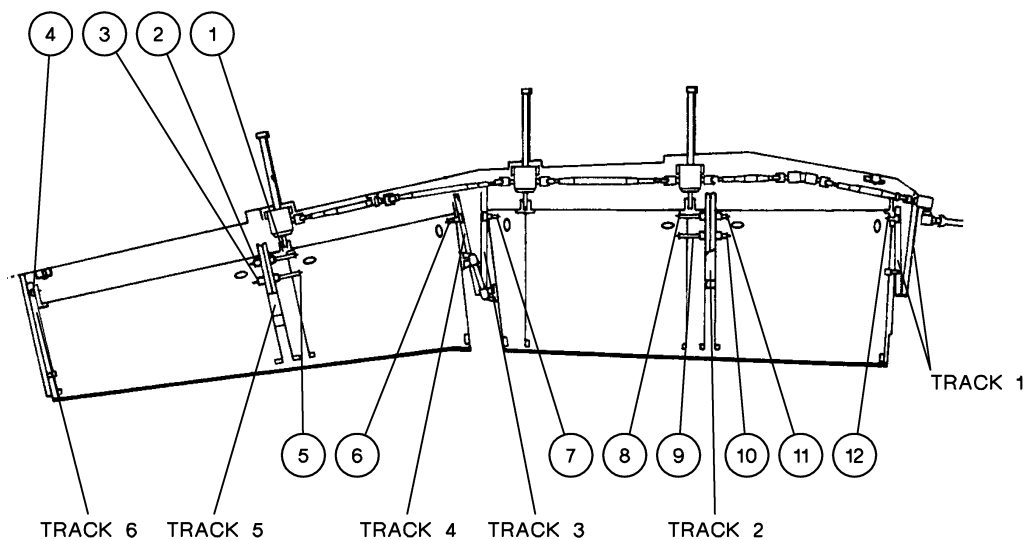
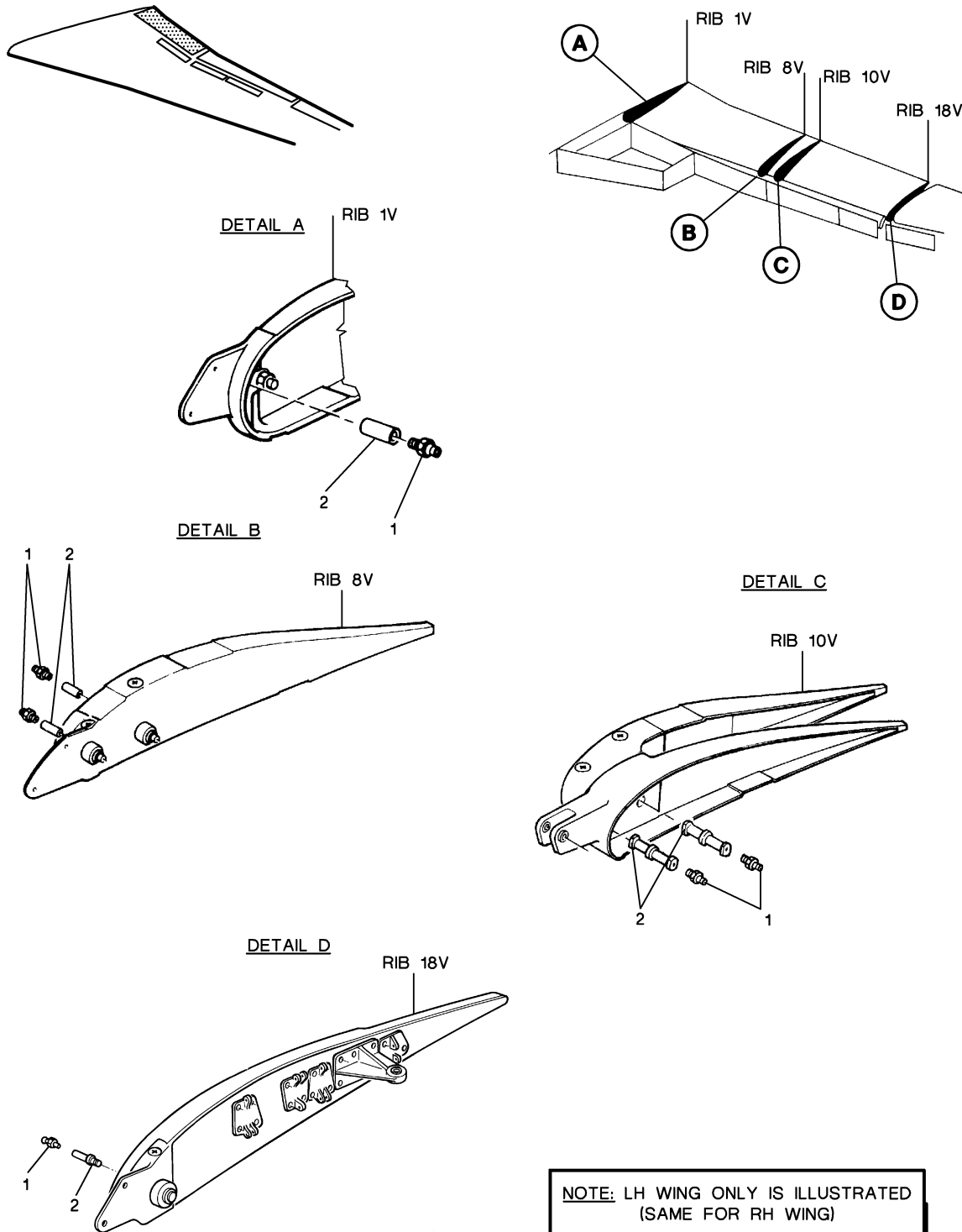

Figure 1: CLEANING/GREASING/LUBRICATION OF FLAP MECHANISMS

FALCON 900EX AIRCRAFT MAINTENANCE MANUAL



**NOTE: LH WING ONLY IS ILLUSTRATED
(SAME FOR RH WING)**

Figure 2: INBOARD FLAP - GREASE NIPPLES